



# CITADEL 2™ LED COMPONENTS

*Style 1 Flat Board Tray System*

*Style 2 Extruded Board Tray System*

*Style 3 Sheet Metal Board Tray System for Wide Distribution*

*Components for Integration of LED Systems*

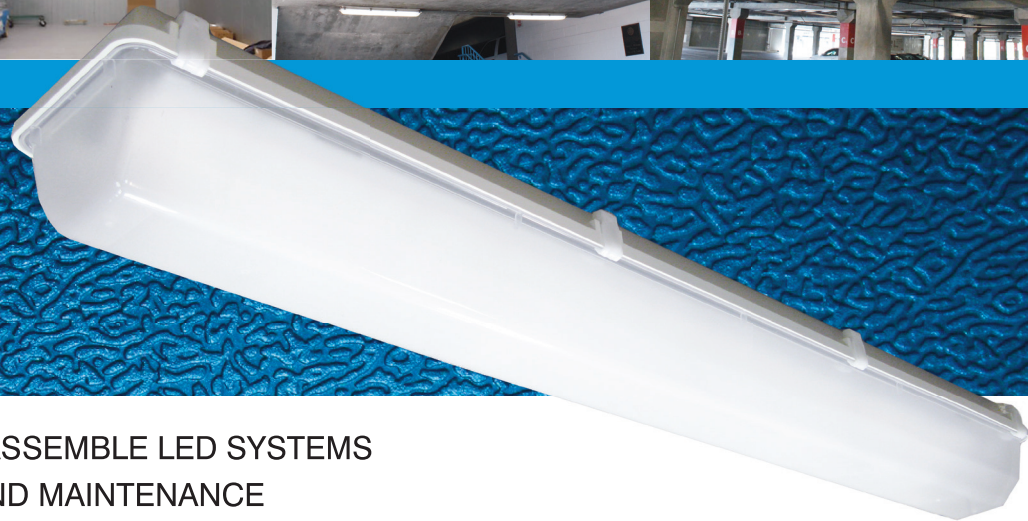

- DESIGNED FOR EASY TO ASSEMBLE LED SYSTEMS
- EASE OF INSTALLATION AND MAINTENANCE
- VISUALLY FAMILIAR LIGHT SOURCING
- MULTIPLE LIGHTING SOLUTIONS
- DesignLights Consortium® QUALIFIED LISTED PRODUCT

**Patent Pending**



*On Specified Configurations  
Visit [www.designlights.org/qpl](http://www.designlights.org/qpl) for Details*

# Board Tray Hardware

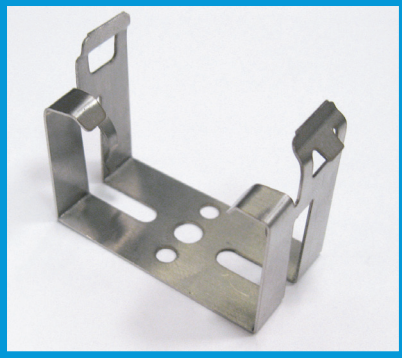

## Wide Retainer Clips

- For Board Trays with Single Center row of LEDs
- 316 Stainless Steel
- **CT-RC-WIDE**



## Traditional CT2 Retainer Clips

- For Board Trays with Two rows of LEDs
- 316 Stainless Steel
- **CT-RC**

**Retainer Clips Easily Installed with CT-SCRW**



## Board Retention Clips

- See Citadel Enclosures Common Components
- **CT-LED-BRC-SM**



## Board Retention Clips Single Row

- See Citadel Enclosures Common Components
- **CT-LED-BRC-SM-S**



# LED Style 1 Board Tray

- Flat Board Tray Designed For LED Board Placement

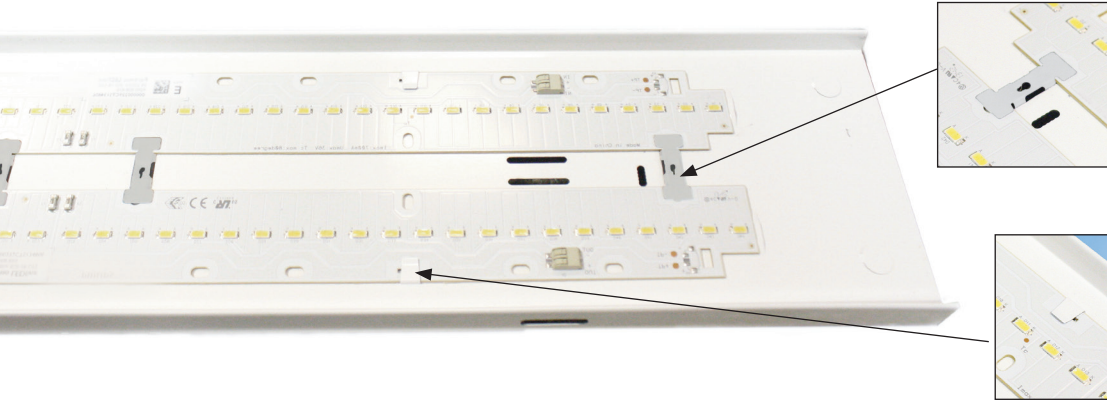

- Board Retention Clips hold boards in position.  
- NO TAPE OR SCREWS

- Lance keeps boards from slipping out of place

## Universal Board Trays

- Single Boardtray for multiple configurations
  - 1 Row or 2 Rows of Linear Zhaga boards
- Board mounting holes 0.110" diameter
  - SLP CT2-LED-SCRW-850
- Ground and driver tray holes 0.140" diameter
  - SLP CT-SCRW-UGT to attached Driver Trays
- 1 or 2 "L" Driver Tray(s) only

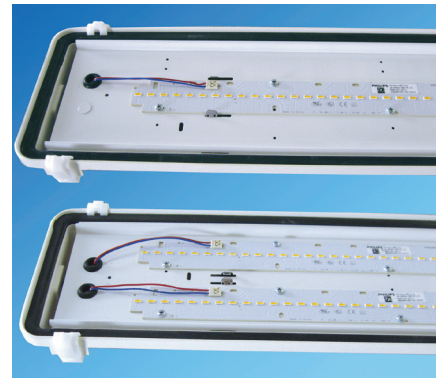

**CT2-LED-BT1-2L2-LZ**  
**CT2-LED-BT1-2L4-LZ**  
**CT2-LED-BT1-2L8-LZ**

# Two Row Board Trays

- Board Trays for Two Rows of LED
- Boards at Typical Board Widths
  - 0.95" & 1.60"
- 2', 4', and 8' Lengths Available
- Custom Designs Available

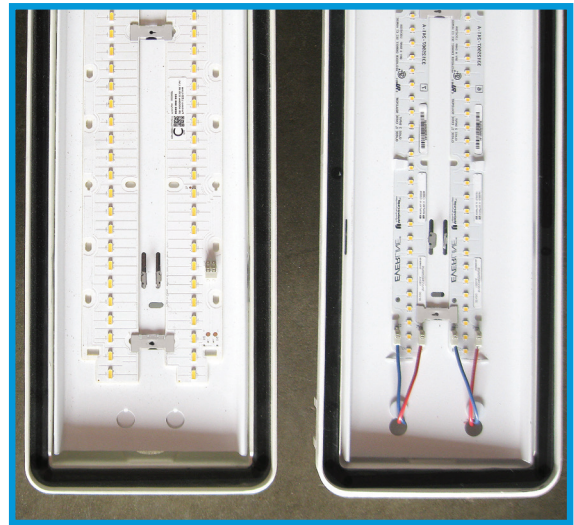

1.60"

0.95"

# Single Center Row

## Wide Center Row of LEDs with Clips

- Wide Board Tray for Single Row of LEDs
- Wide Retainer Clip holds Board Tray in Place
- Lances and Board Retention Clips hold Boards in Place
  - No Tape or Screws Needed
- For Typical Board Widths 0.95" or 1.60"
- 2', 4', and 8' Lengths Available
- Custom Designs Available



1.60"

0.95"

## Narrow Single Center Row Board Tray

- Wide Retainer Clip holds Board Tray in Place
- For Typical Board Widths 1.60" or Less
- Special Board Retention Clip for single row applications



# LED Style 3

## Geartray

- Pre-painted Cold Rolled Steel
- Carries all the electrical gear and keeps separate from the LED Boards
- Installs using traditional Citadel Retainer Clips (CT-RC)
- **CT2-LED-GT3-22-M OR CT2-LED-GT3-24-M**

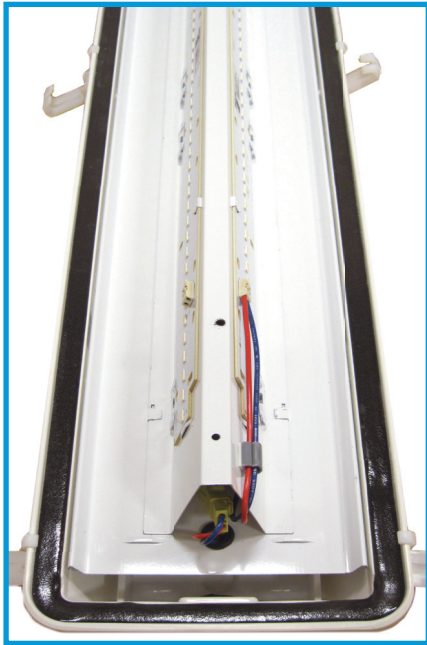
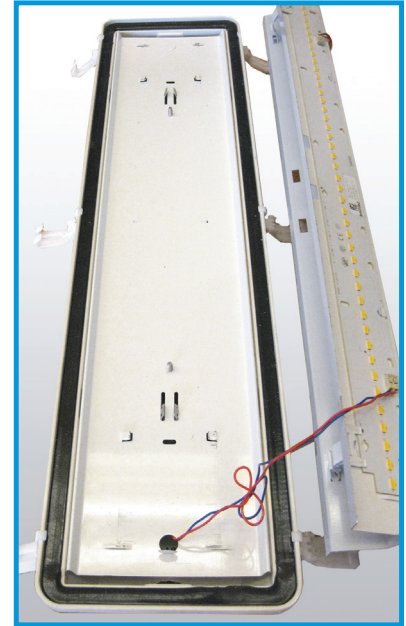

## Board Tray

- Pre-painted Cold Rolled Steel
- Angled design for wide distribution
- 2' and 4' lengths
- For Typical Board widths 1.60"
- Custom Designs Available
- **CT2-LED-BT3-22-M-160 OR CT2-LED-BT3-24-M-160**



Simply snaps into the Geartray Lances

Alignment Ridges keep it centered

- Hinge feature for easy fixture maintenance



# LED Wide Reflector

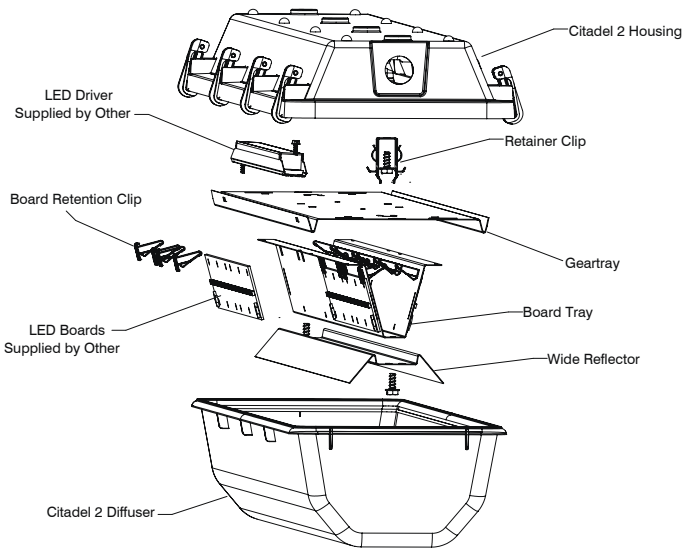

- Reflector creates a wide distribution of LED light
- Installed with CT-SCRW
- Patent Pending
- DLC Parking Garage
- **CT2-LED-RF-2L2-M**  
**OR CT2-LED-RF-2L4-M**

## Ordering Guide

Max weight = 15lbs / 48" 32lbs / 96"

CIT2-LED

Series

CIT2-LED

Size

2 = 2FT  
4 = 4FT  
8 = 8FT

Lumens

2FT	8FT
3166 (17W)	3220 (17W)
4350 (24W)	4480 (24W)
5470 (31W)	5705 (30W)
6452 (39W)	6910 (37W)
	8640 (48W)
	11797 (70W)
4FT	
3220 (17W)	13820 (74W)
4480 (24W)	17280 (96W)
5705 (30W)	23594 (140W)
6910 (37W)	
8640 (48W)	
11797 (70W)	

Color

3K  
35K  
4K  
5K

Options

**EMB**= emergency ballast  
**REFS** = Silver Reflector  
**OCC-E** = External Occupancy  
Sensor **OCC-I** = Internal Occupancy  
Sensor **BILEVEL**= Bi-level system  
**SS**= Stainless Steel Latch  
**POLY**= Polycarb lens  
**FR** = Frosted lens over LED boards

\*0-10v low voltage dimming  
standard per fixture

\*Higher and custom lumen  
packages available upon request

NOTE: Indicate style wanted when ordering



# Certifications

UL

NSF

NEMA 4X

IP65

IP66

IP67

RoHS

PSI 1500

SLP Guardian Seal

Patented



**UL Listing: File E363909**  
**UL Recognized Components: File E215168**  
**Components Tested and Certified**  
**by NSF International**

**NEMA 4X**



Offers 34% more contact between the lens and the gasket. Guardian Seal™ is a unique combination of our Injection Molded lens features and high performance “poured in place” gasket. This provides the most advanced sealing system available.



[www.maeslighting.com](http://www.maeslighting.com)